

College Amenities With Measurement

Sr. No.	Name	Information	Area Covered
1	MAIN BUILDING (CLASSROOMS)	It has 23 No. of rooms serving as Classrooms For B.A. and B.Com. Streams.	16975 sqft.
2	LAB	Soil and Water Testing Lab, English Language Laboratory, Geography Laboratory.	900 sqft.
3	ICT FACILITIES	It has 19 No. of Computer with all internet facilities for students.	700 sqft.
4	WOMEN HOSTEL	It has 17 No. of rooms with capacity of 28 girl's students with all facilities. It has 8 Bathrooms and 8 Toilet blocks.	8000 sqft.
5	GYMKHANA	Gymkhana is enriched by advanced equipments.	900 sqft.
6	YOGA CENTER	It has Yoga Centre facilities for students.	2000 sqft.
7	CULTURAL HALL	It has Cultural facilities for students.	1500 sqft.
8	ADMINISTRATION BUILDING AND LIBRARY	It has Staff Room, Principal's Cabin, Administrative Office, Students Facilitation Center on Ground Floor; First Floor includes Library, Reading Room and IQAC	4000 sqft.
9	PRINCIPAL QUARTER	This is separate facility for Principal's residence in the campus.	1200 sqft.
10	CANTEEN	This is the hygienic place for the provision of healthy food at lowest cost for students and staff.	1000 sqft.
11	N.C.C. OFFICE	Administrative Office for NCC	300 sqft.
12	N.S.S. OFFICE	Administrative Office for NSS	300 sqft.
13	R.O.WATER PLANT	R.O.Water Plant for all students	120 sqft.
14	GIRLS REST ROOM	Girls Rest Room for all girls students	240 sqft.
15	BOYS REST ROOM	Boys Rest Room for all boys students	240 sqft.
16	GIRLS TOILET	It has 8 No. of units with special unit for physically disabled girl's students.	400 sqft.
17	BOYS TOILET	It has 8 No. of units with special unit for physically disabled boy's students.	400 sqft.
18	PLAY GROUND WITH 400 MTRS RUNNING TRACK	It has the space for outdoor games surround by 400 mtrs. Running Track	4 acres
19	PLAY GROUND WITH RUNNING TRACK FOR GIRLS	This is a separate ground for girl students with Running Track.	
20	COLLEGE AGRICULTURAL FIELD	From this field the colleges take the crop of Tur, Jowar etc.	6 acres
21	CUSTARD APPLE ORCHARD	The plantation of 500 plants of Golden Custard Apple is done over here. It is facilitated with Drip irrigation.	1 acres
22	MANGO ORCHARD	The plantation of 200 plants of different Mango is done over here. It is facilitated with Drip irrigation.	1 acres
23	EARTHEN WATER POND	The farm pond fulfilled the need of water for college agricultural field. It has 70 lakh liters capacity. This is now enriched with Aquaculture farming with 10000 fish seeds.	9000 sqft.



Co-ordinator,
I.Q.A.C.
Arts & Commerce College,
Madha, Dist. Solapur.



Principal,
Arts & Commerce College
Madha, Dist. Solapur

MAP WITH SIGNAGE BOARD

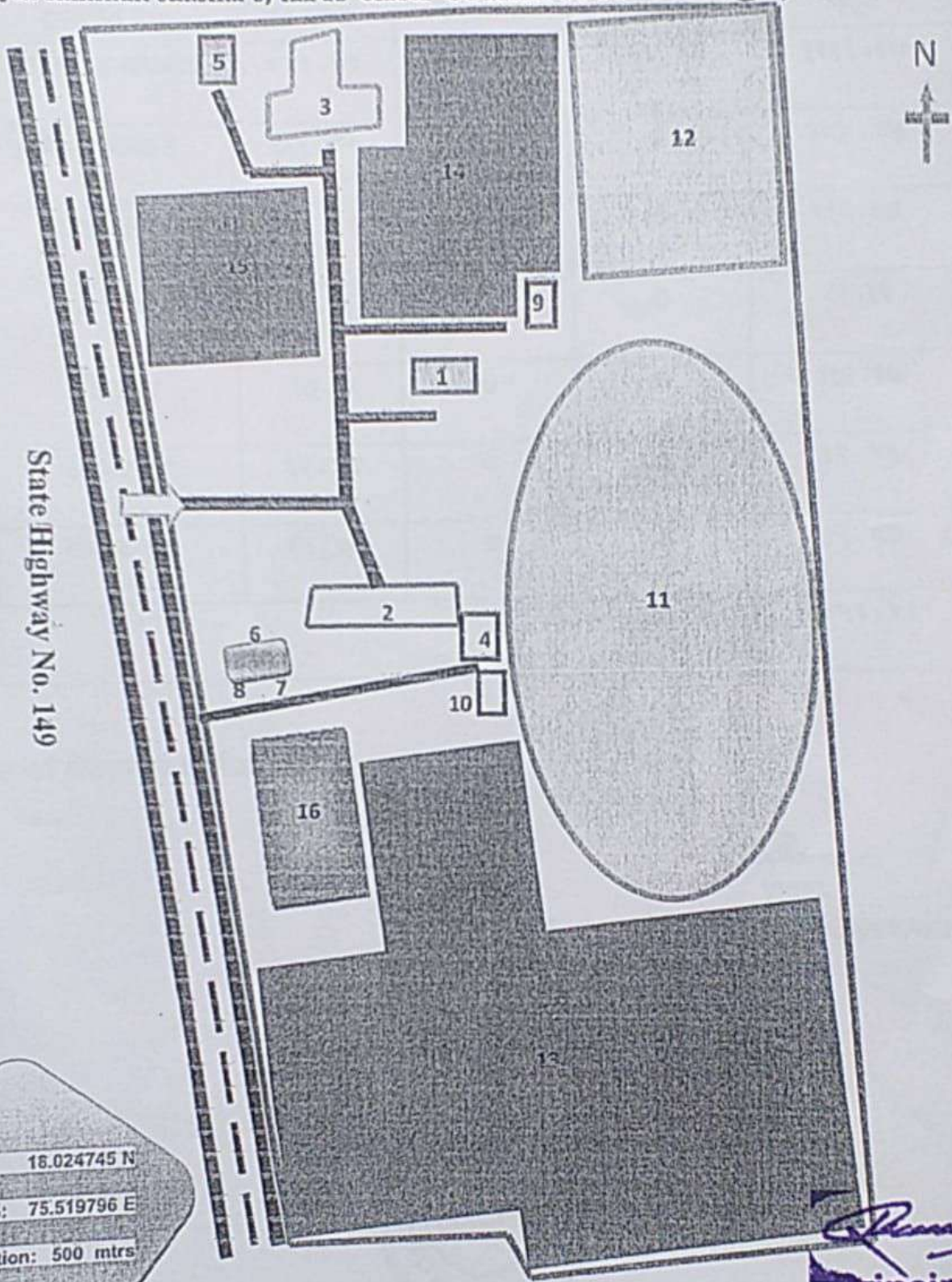
Rayat Shikshan Sanstha's, Arts and Commerce College, Madha



LAT: 18.024745 N
LONG: 75.519796 E
Elevation: 500 mtrs

[Signature]
Principal,
Arts & Commerce College
Madha, Dist. Solapur

[Signature]
Principal,
Arts & Commerce College
Madha, Dist. Solapur

Co-ordinator,
I.Q.A.C.
& Commerce College,
the Dist. Solapur.



बांधकामाचे क्षेत्रफळ

इमारतीचे नाव	तळ मजला	प.मजला	दु.मजला	एकूण
वर्ग खोल्या बांधकाम	४४६.६०	४४६.६०	४४६.६०	१३३९.८०
प्रशस्त लायब्ररी	१८१.८२	१८१.८२	०	३६३.६४
महिला वस्ती गृह	२७१.९३	३०४.०७	०	५७६.००
प्राचार्य निवास	८१.१६	०	०	८१.१६
जीमखाना	११०.१९	०	०	११०.१९
टॉयलेट मुले	३२.४३	०	०	३२.४३
टॉयलेट मुली	३५.४०	०	०	३५.४०
एकूण				२४५९.४३

वरील सर्व मोजमाप स्केअर मीटर मध्ये आहे .



Ravi

प्राचार्य,
कला व वाणिज्य महाविद्यालय, माढा .

गाव नमुना सार
अधिकार अभिलेख पत्रक
[महाराष्ट्र जमीन महसूल अधिकार अभिलेख आणि नोंदवह्या (तयार करणे व सुस्थितीत ठेवणे) नियम, 1961 यातील नियम 29, 6 आणि 6]

गाव :- माढा तालुका :- माढा जिल्हा :- सोलापूर शेवटचा फेरफार क्रमांक :- व दिनांक :-

भुमापन क्रमांक व उपविभाग 447		भू.धारणा पध्दती भोगवट्यादार वर्ग :-1	भोगवट्यादाराचे नांव			खाते क्रमांक	
शेताचे स्थानिक नाव :-			क्षेत्र	आकार	पो.ख.	फे.फा	
क्षेत्र एकक	आर.चौ.मी	रयत शिक्षण संस्था सातारा तर्फे सधिव	4.12.00	4.15		(5378)	733
बिन शेती	4.12.00						कळाचे नाव
बिन शेती आकारणी	4.15						इतर अधिकार
जिरायत	-						इतर
बागायत	-						एक बीअर. (5378)
तरी	-						
वरकस	-						
इतर	-						
एकूण क्षेत्र	-						
पोट-खराब (लागवडीस अयोग्य)	-						
वर्ग (अ)	-						
वर्ग (ब)	-						
एकूण पो ख	0.00.00						
अधिकारणी	0.00						
जूडी किंवा विशेष	-						
अधिकारणी	-						
फेरफार क्र (1)(12)(136)(138)(208)(295)(844)(883)(999)(1346)							सीमा आणि भुमापन चिन्ह :-

गाव नमुना सार
पिकांची नोंदवह्या
[महाराष्ट्र जमीन महसूल अधिकार अभिलेख आणि नोंदवह्या (तयार करणे व सुस्थितीत ठेवणे) नियम, 1961 यातील नियम 29]
ता.माढा जिल्हा :- सोलापूर शेवटचा फेरफार क्रमांक :- व दिनांक :-

वर्ष	हंगाम	पिकाखालील क्षेत्राचा तपशील									लागवडीसाठी उपलब्ध नसलेली जमीन		जल सिंचनाचे साधन	शेरा
		मिश्र पिकाखालील क्षेत्र			घटक पिके व प्रत्येकाखालील क्षेत्र			निर्मळ पिकाखालील क्षेत्र			स्वरूप	क्षेत्र		
		मिश्रणाचा संकेत क्रमांक	जल सिंचित	अजल सिंचित	पिकांचे नाव	जल सिंचित	अजल सिंचित	पिकांचे नाव	जल सिंचित	अजल सिंचित				
(1)	(2)	(3)	(4)	(5)	(6)	(7)	(8)	(9)	(10)	(11)	(12)	(13)	(14)	(15)
			आर. चौ.मी	आर. चौ.मी		आर. चौ.मी	आर. चौ.मी		आर. चौ.मी	आर. चौ.मी		आर. चौ.मी		
2017-18	रब्बी							ज्वारी		0.6000	पड	4.1200		

"या प्रमाणित प्रतीसाठी फी म्हणून 14/- रुपये मिळाले."
दिनांक :- 14/06/2019
सांकेतिक क्रमांक :- 273000020368080000620191166

(नाव :- समाधान भिवा पाटील)
तलाठी साह्या :- ता :- माढा जि :- सोलापूर

AT785787

Arts & Commerce College,
Madha, Dist. Solapur

Co-ordinator,
I.Q.A.C.
Arts & Commerce College,
Madha, Dist. Solapur.



Principal,
Arts & Commerce College
Madha, Dist. Solapur

गाव नमुना सात
अधिकार अभिलेख पत्रक
[महाराष्ट्र जमीन महसूल अधिकार अभिलेख आणि नोंदवह्या (तयार करणे व सुस्थितीत ठेवणे) नियम, 1961 यातील नियम 3,4,5 आणि 6]

गाव :- माढा तालुका :- माढा जिल्हा :- सोलापूर शेवटचा फेरफार क्रमांक :- व दिनांक :-

भुमापन क्रमांक व उपविभाग 448	अ.धारणा पध्दती भौगोलिक वर्ग - 1	भोगवटादाराचे नाव	क्षेत्र	आकार	पो.ख.	फे.फा	छाते क्रमांक
शेताचे स्थानिक नाव :-							
क्षेत्र एकक	हे.आर.चौ.मी	रयत शिक्षण संस्था सातारा तर्फे सचिव	3.75.00	3.90	0.06.00	(1346)	733
जिरायत	3.75.00						कळाचे नाव
बागायत	.						इतर अधिकार
तरी	.						
वरकस	.						
इतर	.						
एकूण क्षेत्र	3.75.00						
पोट-खराब (सागवडीस अयोग्य)							
वर्ग (अ)	0.06.00						
वर्ग (ब)							
एकूण पो.ख.	0.06.00						
आकारणी	3.90						
जूडी किंवा विशेष	.						
आकारणी	.						
जने फेरफार क्र. (1),(139),(207),(295),(844),(883),(1346)							सीमा आणि भुमापन चिन्हे :

गाव नमुना बारा
पिकांची नोंदवह्या
[महाराष्ट्र जमीन महसूल अधिकार अभिलेख आणि नोंदवह्या (तयार करणे व सुस्थितीत ठेवणे) नियम, 1961 यातील नियम 29]
तालुका :- माढा जिल्हा :- सोलापूर शेवटचा फेरफार क्रमांक :- व दिनांक :-

गाव :- माढा		पिकांसाठी उपलब्ध नसलेली जमीन											जल सिंचनाचे साधन	शेरा
भुमापन क्रमांक व उपविभाग : 448		पिकांसाठी उपलब्ध नसलेली जमीन						निर्भळ पिकांसाठी उपलब्ध नसलेली जमीन						
		निर्भळ पिकांसाठी उपलब्ध नसलेली जमीन			पट्टक पिके व प्रत्येकासाठी उपलब्ध नसलेली जमीन			निर्भळ पिकांसाठी उपलब्ध नसलेली जमीन						
वर्ष	हंगाम	मिश्रणाचा संकेत क्रमांक	जल सिंचित	अजल सिंचित	पिकांचे नाव	जल सिंचित	अजल सिंचित	पिकांचे नाव	जल सिंचित	अजल सिंचित	स्वरूप	क्षेत्र		
(1)	(2)	(3)	(4)	(5)	(6)	(7)	(8)	(9)	(10)	(11)	(12)	(13)	(14)	(15)
2017-18	रब्बी		हे.आर. चौ.मी	हे.आर. चौ.मी	हे.आर. चौ.मी	हे.आर. चौ.मी		ज्वारी		3.7000	पड	0.0500		

"या प्रमाणित प्रतीसाठी फी म्हणून 14/- रुपये मिळाले."
दिनांक :- 14/06/2019
सांकेतिक क्रमांक :- 273000020368080000620191167

(नाव :- समाधान भिवा पाटील)
तलाठी साझा :- ता :- माढा जि :- सोलापूर

Principal

Principal,
Arts & Commerce College,
Madha Dist. Solapur.

मौजे माढा ता. माढा

Co-ordinator,
I.Q.A.C.
Arts & Commerce College,
Madha. Dist. Solapur.



Principal,
Arts & Commerce College
Madha, Dist. Solapur

वर्ष: 2018-19

गाव नमुना आठ-अ
धारण जमिनीची नोंदवही (कृषिक)
(आसामीवार खतावणी -- जमाबंदी पत्रक)

गाव: माढा

तालुका: माढा

जिल्हा: ...

गाव नमुना सहा मधील नोंद	भूमापन क्रमांक व उपविभाग क्रमांक	क्षेत्र	क्षेत्र	एकूण क्षेत्र	आकारणी किंवा जुडी	दुमाला जमिनीवरील नुकसान.	स्थानिक उपकरण	जि.प. ग्रा. प.		
(१)	(२)	(३अ)	(३ब)	(३क)	(४)	(५)	(६अ)	(६ब)		
		लागवडी योग्य क्षेत्र	पोटखराब क्षेत्र	एकूण क्षेत्र	आकारणी किंवा जुडी	दुमाला जमिनीवरील नुकसान.	स्थानिक उपकरण	जि.प. ग्रा. प.		
		(हे.आर.चौ.मी)	(हे.आर.चौ.मी)	(हे.आर.चौ.मी)						
		(१)	(२)	(३अ)	(३ब)	(३क)	(४)	(५)	(६अ)	(६ब)
-खाते क्रमांक 733	रयत शिक्षण संस्था सातारा तर्फे सचिव.									
शैक्षणिक संस्था	348	1.05.00	0.04.00	1.09.00	0.95	0	6.65	0.95		
	349/1	5.77.00	0.19.00	5.96.00	6.35	0	44.45	6.35		
	448	3.75.00	0.06.00	3.81.00	3.9	0	27.3	3.9		
एकूण		10.57.00	0.29.00	10.86.00	11.20	0	78.40	11.20		

"या प्रमाणित प्रतीसाठी फी म्हणून ₹५/- रुपये मिळाले."

दिनांक :- 14/06/2019

(नाव :- समाधान भिवा पाटील)

सांकेतिक क्रमांक :- 273000020368080000620192171

तलाठी साझा :-
ता :- माढा जि :- सोलापूर

वर्ष: 2018-19

गाव नमुना आठ-अ
धारण जमिनीची नोंदवही (अकृषिक)
(आसामीवार खतावणी -- जमाबंदी पत्रक)

6/14/20

गाव: माढा

तालुका: माढा

जिल्हा: सोला

गाव नमुना सहा मधील नोंद	भूमापन क्रमांक व उपविभाग क्रमांक	क्षेत्र	क्षेत्र	एकूण क्षेत्र	आकारणी किंवा जुडी	दुमाला जमिनीवरील नुकसान.	स्थानिक उपकरण	जि.प. ग्रा. प.
		लागवडी योग्य क्षेत्र	पोटखराब क्षेत्र	एकूण क्षेत्र	आकारणी किंवा जुडी	दुमाला जमिनीवरील नुकसान.	स्थानिक उपकरण	जि.प. ग्रा. प.
		(आर.चौ.मी)	(आर.चौ.मी)	(आर.चौ.मी)				



Co-ordinator,
I.Q.A.C.
Arts & Commerce College,
Madha

Friday, June 14, 2019
Principal,
Arts & Commerce College

(१)	(२)	(३अ)	(३ब)	(३क)	(४)	(५)	(६अ)	(६ब)	(६)
खाते क्रमांक रयत शिक्षण संस्था सातारा तर्फे सचिव . 733									
शेक्षणिक संस्था	447	4.12.00	0.0000	4.12.00	4.15	0	29.05	4.15	37.2
एकूण		4.12.00	0.0000	4.12.00	4.15	0	29.05	4.15	37.2

"या प्रमाणित प्रतीसाठी फी म्हणून १५/- रुपये मिळाले."

दिनांक :- 14/06/2019

(नाव :- समाधान भिवा पाटील)

सांकेतिक क्रमांक :- 273000020368080000620192171

तलाठी साझा :-
ता :- माढा जि :- सोलापूर

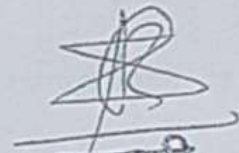

तलाठी
मौजे माढा ता. माढा

ATTENDED

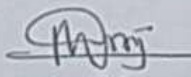

Principal,
Arts & Commerce College,
Madha, Dist. Solapur.

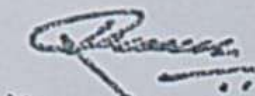
Co-ordinator,
I.Q.A.C.
Arts & Commerce College,
Madha, Dist. Solapur.

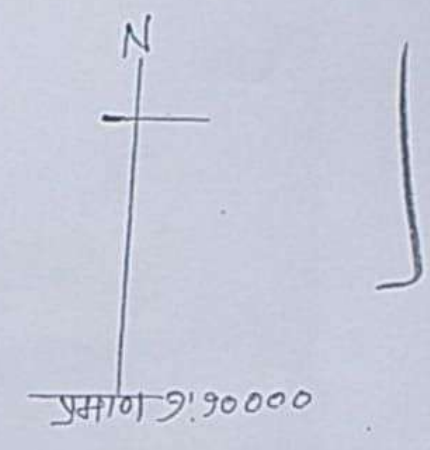
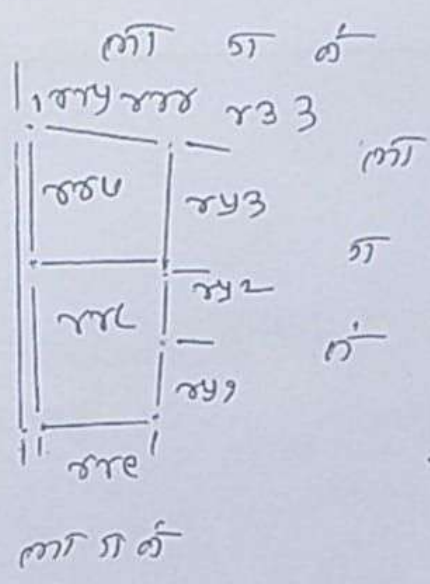

Principal,
Arts & Commerce College
Madha, Dist. Solapur

सीजे - माडा ना - माडा मेरीन ज. नं. ४४७, ४४८ ची नकशेला गाट
 बुवाकले लागू कारणापुरी तयार केळी घसे



अर्जा प्राप्त दि. N/209
 नकशे तयार दि. 28/5/209
 मकदमा खिला दि. 209
 नकशे तयार करणार
 नकशे नकल
 मुख्यालय सहायक
 उच्च अधिसूचना भूमि अधिनियम
 नकल फ्री १००
 नकल फ्री १००
 तयार करी.
 एडू १००

ATTESTED

Principal,
 Arts & Commerce College,
 Madha, Dist. Solapur.

Co-ordinator,
 I.Q.A.C.
 Arts & Commerce College,
 Madha, Dist. Solapur.



Principal,
 Arts & Commerce College
 Madha, Dist. Solapur

"Education through Self-Help is Our Motto"-Karmaveer
Rayat Shikshan Sanstha's

Arts and Commerce College, Madha Dist. Solapur



Main Building (Classroom)

Co-ordinator,
I.Q.A.C.

Arts & Commerce College,
Madha, Dist. Solapur.



Principal,
Arts & Commerce College
Madha, Dist. Solapur



"Education through Self-Help is Our Motto"-Karmaveer
Rayat Shikshan Sanstha's

Arts and Commerce College, Madha

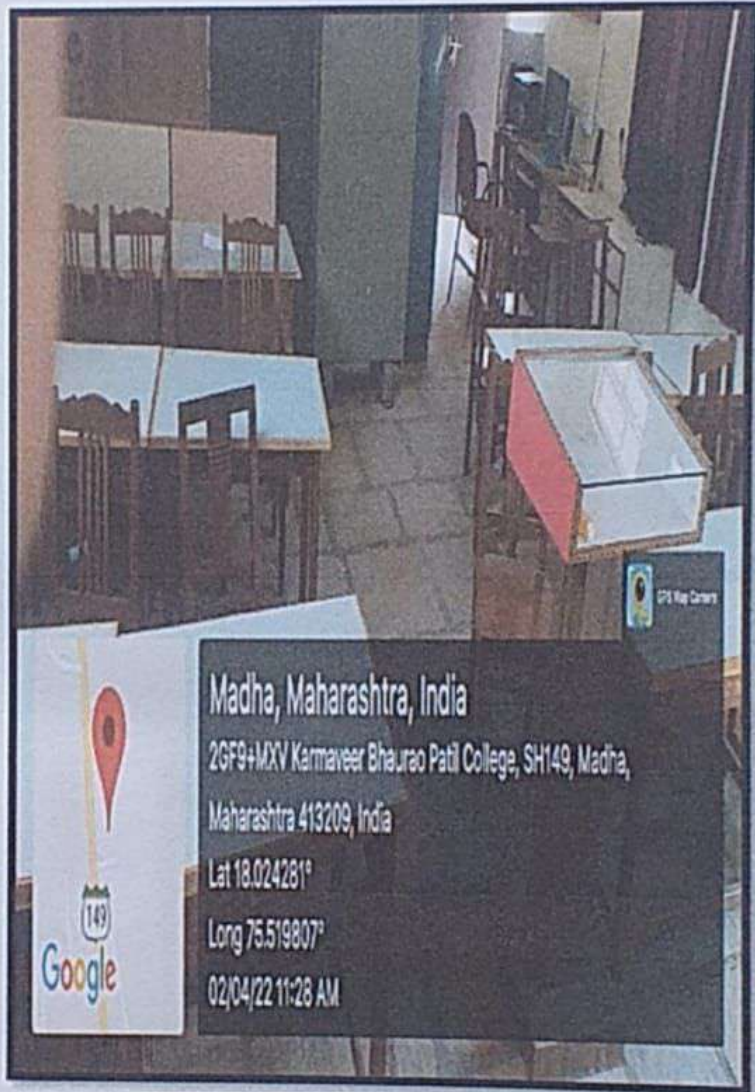
Dist. Solapur



Department of Geography



"Education through Self-Help is Our Motto"-Karmaveer
Rayat Shikshan Sanstha's

Arts and Commerce College, Madha

Dist. Solapur

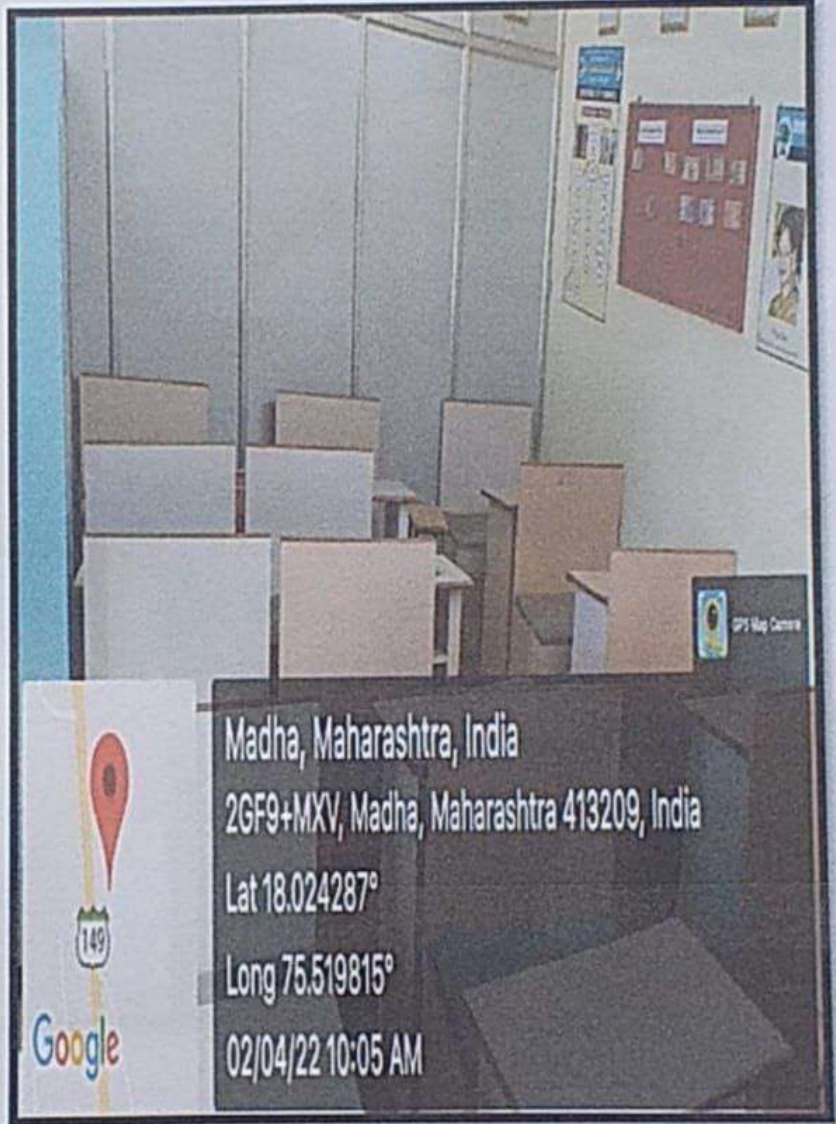

Department of Economics



"Education through Self-Help is Our Motto" - Karmaveer
Rayat Shikshan Sanstha's

Arts and Commerce College, Madha

Dist. Solapur

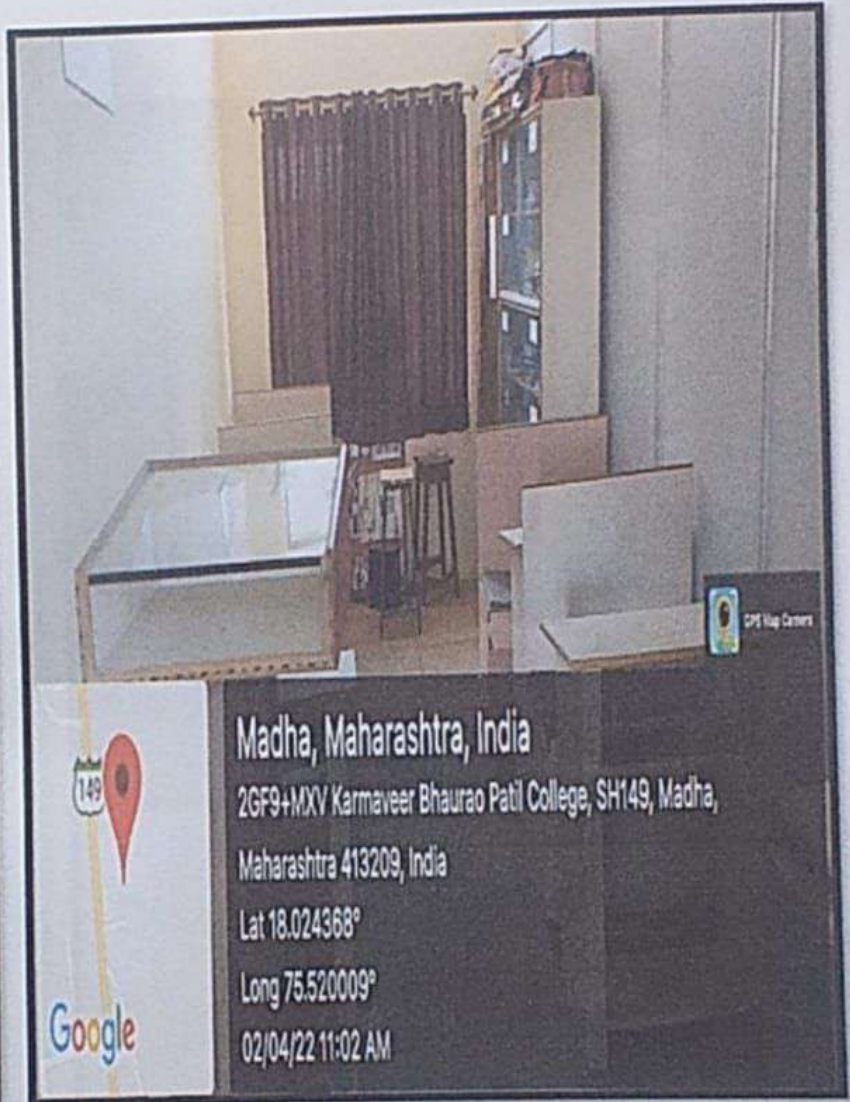
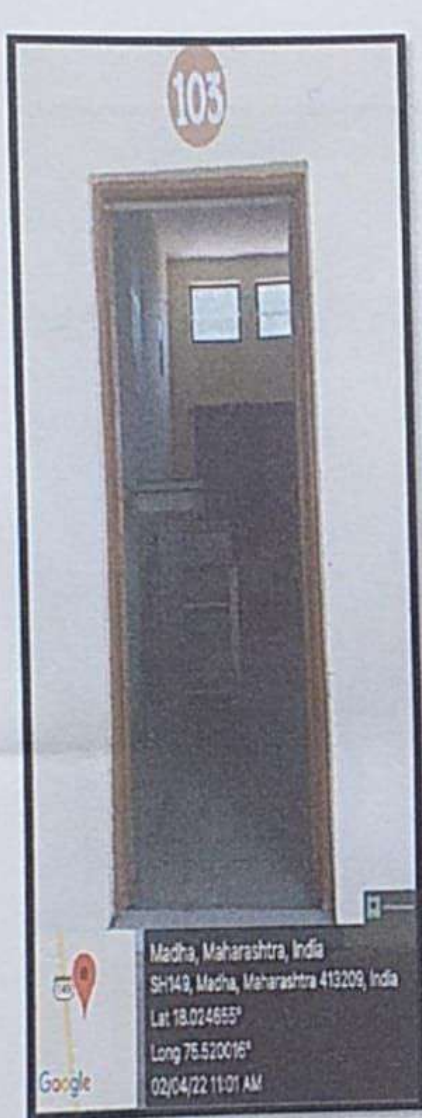

Department of Hindi



"Education through Self-Help is Our Motto"-Karmaveer

Rayat Shikshan Sanstha's

Arts and Commerce College, Madha

Dist. Solapur

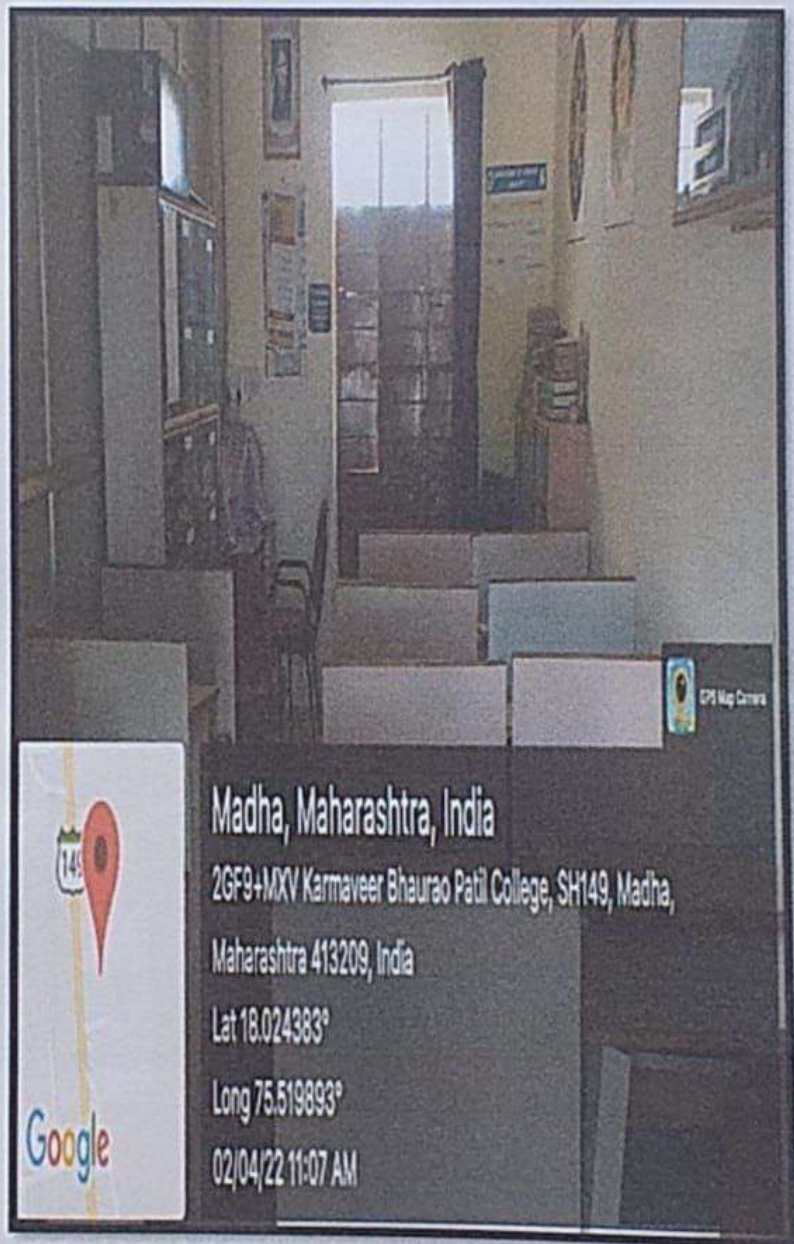

Department of Marathi



"Education through Self-Help is Our Motto"-Karmaveer
Rayat Shikshan Sanstha's

Arts and Commerce College, Madha

Dist. Solapur

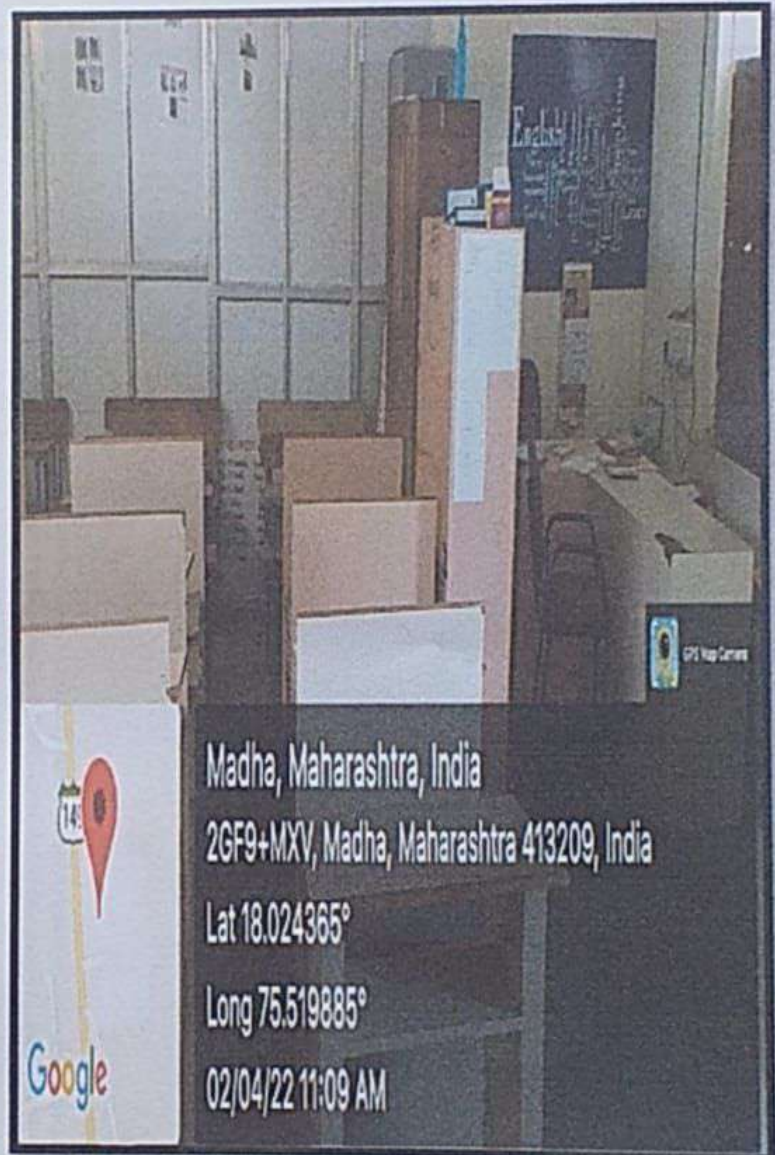

Department of English



"Education through Self-Help is Our Motto"-Karmaveer

Rayat Shikshan Sanstha's

Arts and Commerce College, Madha

Dist. Solapur

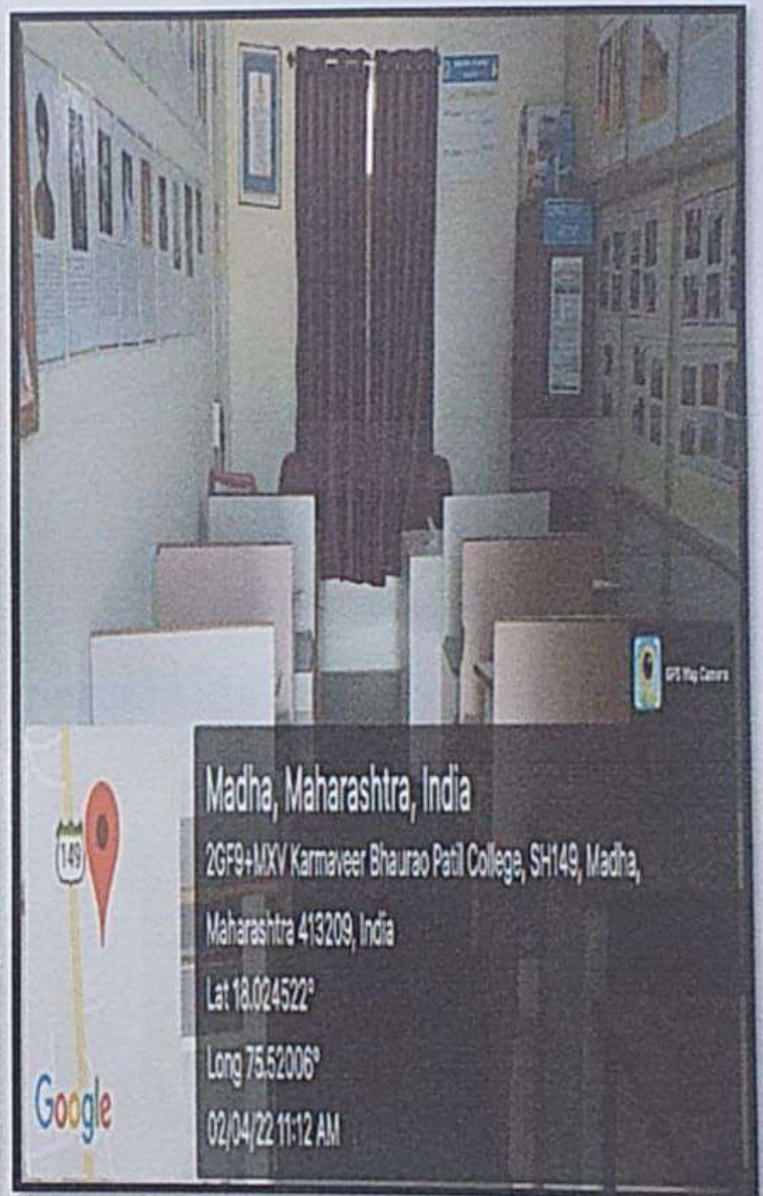

Department of History



"Education through Self-Help is Our Motto" -Karmaveer

Rayat Shikshan Sanstha's

Arts and Commerce College, Madha

Dist. Solapur

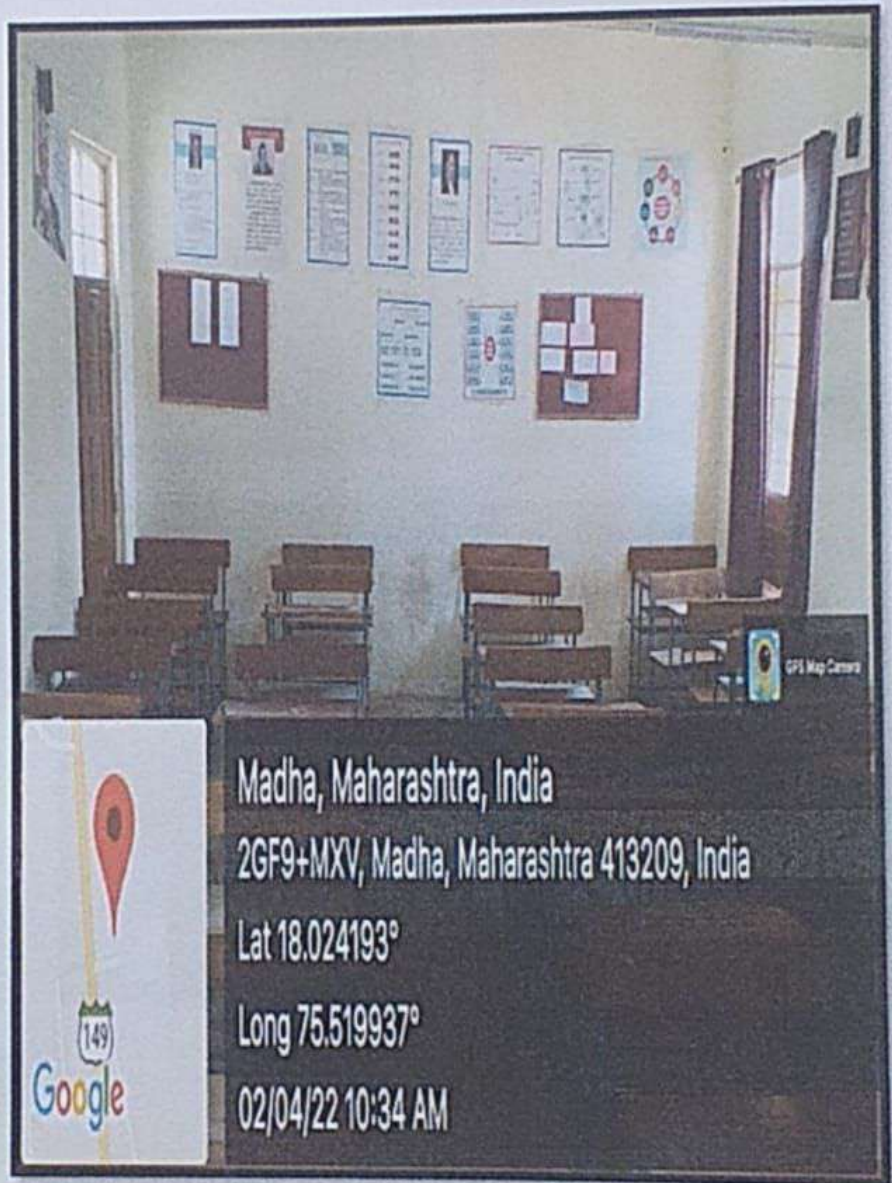
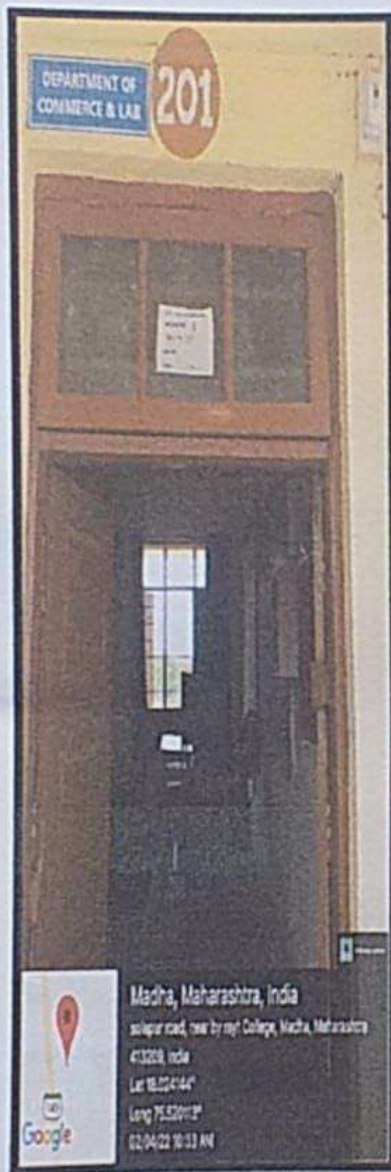

Department of Commerce



"Education through Self-Help is Our Motto"-Karmaveer
Rayat Shikshan Sanstha's

Arts and Commerce College, Madha

Dist. Solapur

Classrooms



"Education through Self-Help is Our Motto" -Karmaveer
Rayat Shikshan Sanstha's

Arts and Commerce College, Madha

Dist. Solapur

Classrooms

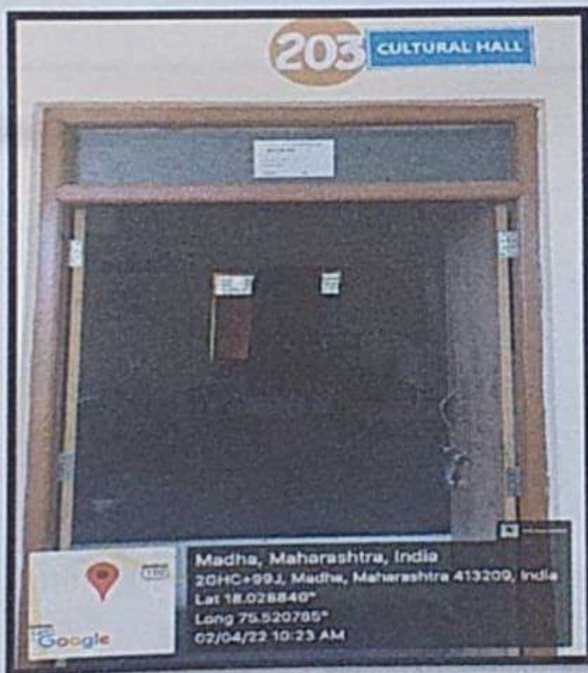

"Education through Self-Help is Our Motto"-Karmaveer
Rayat Shikshan Sanstha's

Arts and Commerce College, Madha

Dist. Solapur

Classrooms

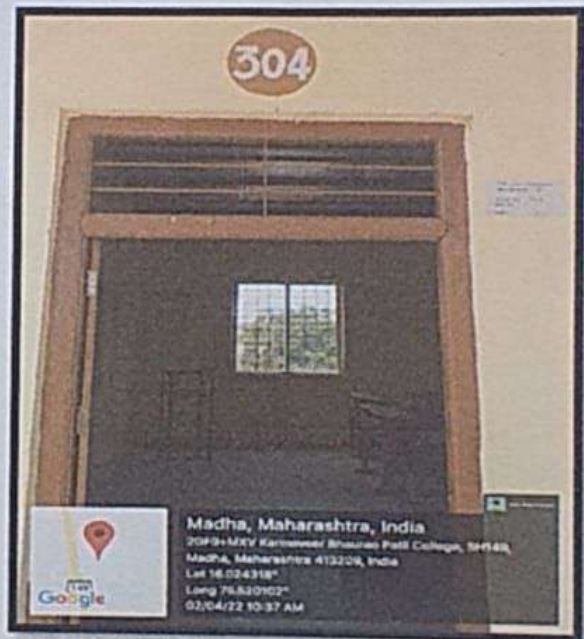

"Education through Self-Help is Our Motto" - Karmaveer
Rayat Shikshan Sanstha's

Arts and Commerce College, Madha

Dist. Solapur



Google

Madha, Maharashtra, India
SH149, Madha, Maharashtra 413209, India
Lat 18.024547°
Long 75.520163°
17/03/22 08:58 AM

Google

Madha, Maharashtra, India
SH149, Madha, Maharashtra 413209, India
Lat 18.024543°
Long 75.520173°
17/03/22 08:58 AM



"Education through Self-Help is Our Motto" - Karmaveer

Rayat Shikshan Sanstha's

Arts and Commerce College, Madha

Dist. Solapur



"Education through Self-Help is Our Motto" - Karmaveer

Rayat Shikshan Sanstha's

Arts and Commerce College, Madha

Dist. Solapur

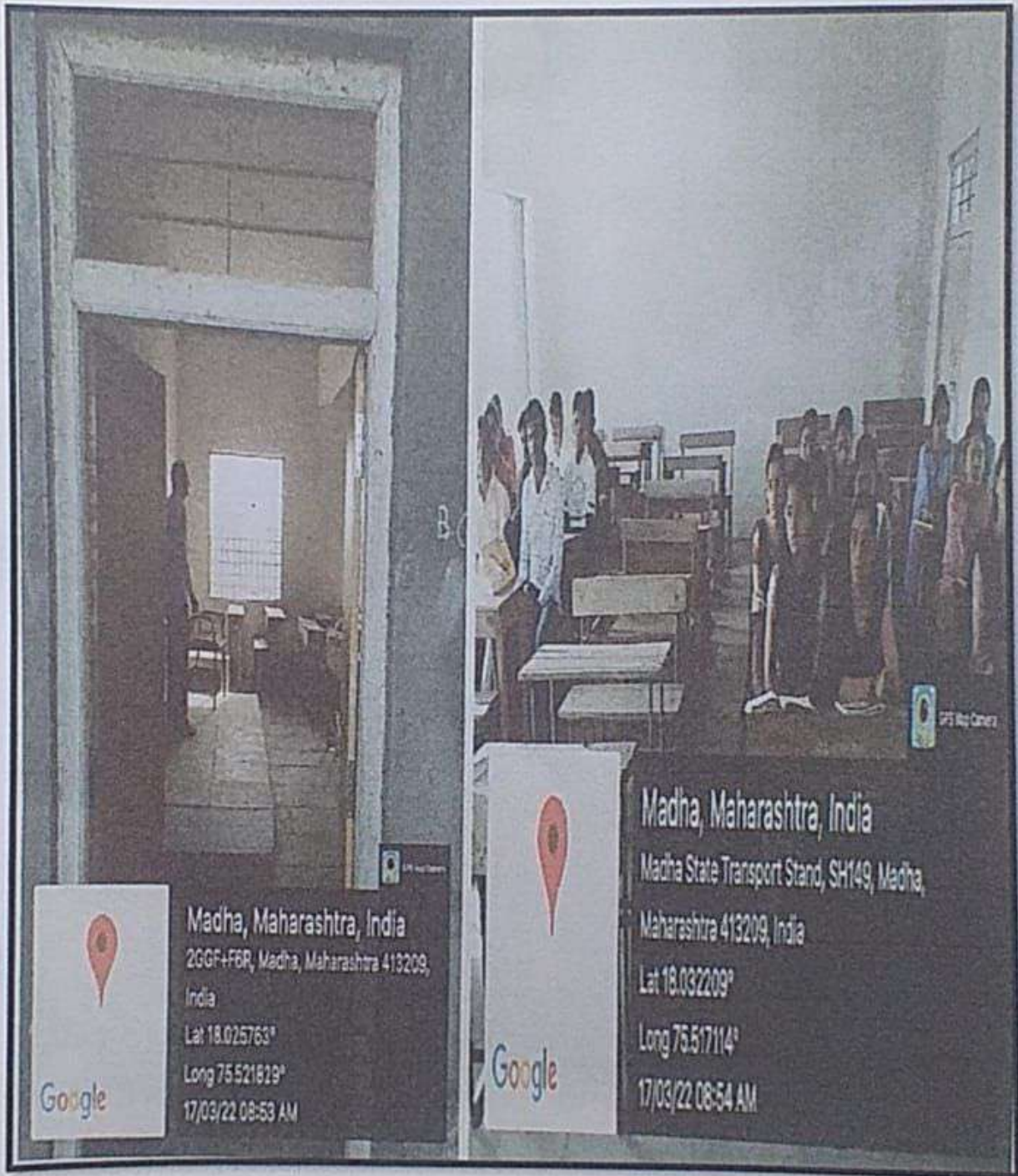

110



"Education through Self-Help is Our Motto" - Karmaveer
Rayat Shikshan Sanstha's

Arts and Commerce College, Madha

Dist. Solapur



"Education through Self-Help is Our Motto" - Karmaveer

Rayat Shikshan Sanstha's

Arts and Commerce College, Madha

Dist. Solapur

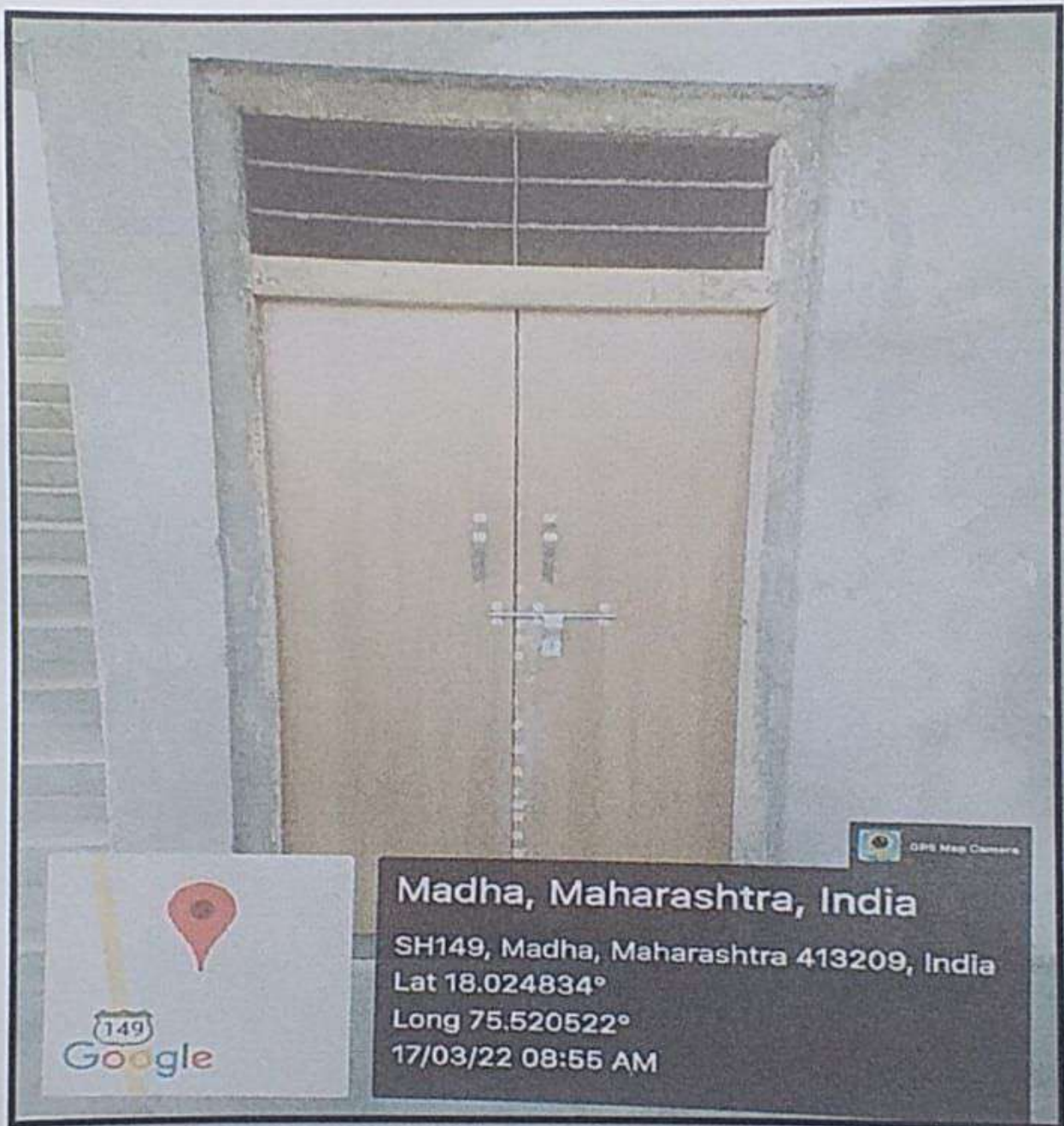

112



"Education through Self-Help is Our Motto"-Karmaveer
Rayat Shikshan Sanstha's

Arts and Commerce College, Madha

Dist. Solapur



205



"Education through Self-Help is Our Motto"-Karmaveer
Rayat Shikshan Sanstha's

Arts and Commerce College, Madha

Dist. Solapur



206



"Education through Self-Help is Our Motto" -Karmaveer
Rayat Shikshan Sanstha's

Arts and Commerce College, Madha

Dist. Solapur



207



"Education through Self-Help is Our Motto"-Karmaveer
Rayat Shikshan Sanstha's

Arts and Commerce College, Madha Dist. Solapur



208

Co-ordinator,
I.Q.A.C.
Arts & Commerce College,
Madha, Dist. Solapur.



Principal,
Arts & Commerce College
Madha, Dist. Solapur

"Education through Self-Help is Our Motto"-Karmaveer
Rayat Shikshan Sanstha's

Arts and Commerce College, Madha Dist. Solapur



Soil and Water Testing Lab

Co-ordinator,
I.Q.A.C.
Arts & Commerce College,
Madha, Dist. Solapur.



Principal,
Arts & Commerce College
Madha, Dist. Solapur

RayatShikshanSanstha's
Arts and Commerce College, Madha
Department of English

List of Laboratory Equipment

Sr. No.	Name of the Equipment	Number
1.	Audio-visual Booth with head phone each	10
2.	Computer Desktop	01
3.	Workstation	01
4.	LCD project	01
5.	Software	01
6.	Television	01
7.	DVDs and Audio -Visual Cassettes	23
8.	Chairs	15
9.	Tables	03

Head,
 Department of English
 Arts & Commerce College
 Madha, Dist. Solapur

Co-ordinator,
I.Q.A.C.
 Arts & Commerce College,
 Madha, Dist. Solapur.

Principal,
 Arts & Commerce College
 Madha, Dist. Solapur



"Education through Self-Help is Our Motto" -Karmaveer
Rayat Shikshan Sanstha's

Arts and Commerce College, Madha

Dist. Solapur



English Language Laboratory

Co-ordinator,
I.Q.A.C.

Arts & Commerce College,
Madha, Dist. Solapur.



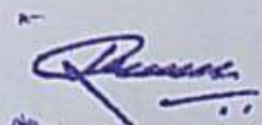

Principal,
Arts & Commerce College
Madha, Dist. Solapur

Dept. of Geography Equipments and Facilities

Sr. No.	Name of the Equipments	No.
1	Computers , Printer and Scanner	06
2	Laptop	01
3	GPS	01
4	L.C.D. Projector	01
5	Mirror Stereoscope	02
6	Pocket Stereoscope	08
7	Aerial Photographs	12
8	Maps & Outlines	157
9	Toposheets	64
10	Weather Charts	139
11	Weather Instruments	11
12	Cartographic Instruments	12
13	Surveying & Leveling Instruments	18
14	Globe	2
Coordinator <i>Affulka</i>		1
Tracing Table		1
Head,		
I.Q.A.C.		

Department of Geography,
Arts & Commerce College,
Madha, Dist. Solapur.

Arts & Commerce College,
Madha, Dist. Solapur.

Departmental Library

Sr. No.	Particulars	No.
1	Reference Books	61
2	Encyclopedia	03
	Volume	09
3	Geographical Dictionaries	05
4	Syllabus File	
5	Previous Question Papers' Bank	



Principal,
Arts & Commerce College
Madha, Dist. Solapur

"Education through Self-Help is Our Motto"-Karmaveer
Rayat Shikshan Sanstha's

Arts and Commerce College, Madha

Dist. Solapur

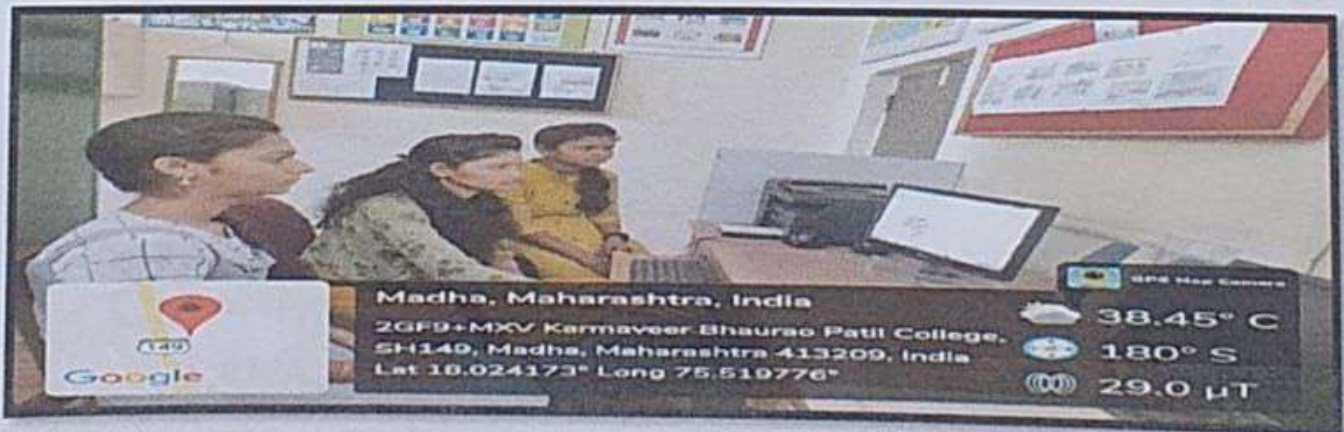

Geography Laboratory

[Signature]
Co-ordinator,
I.Q.A.C.

Arts & Commerce College,
Madha, Dist. Solapur.



[Signature]

Principal,
Arts & Commerce College
Madha, Dist. Solapur

"Education through Self-Help is Our Motto"-Karmaveer

Rayat Shikshan Sanstha's

Arts & Commerce College, Madha

Dist. Solapur

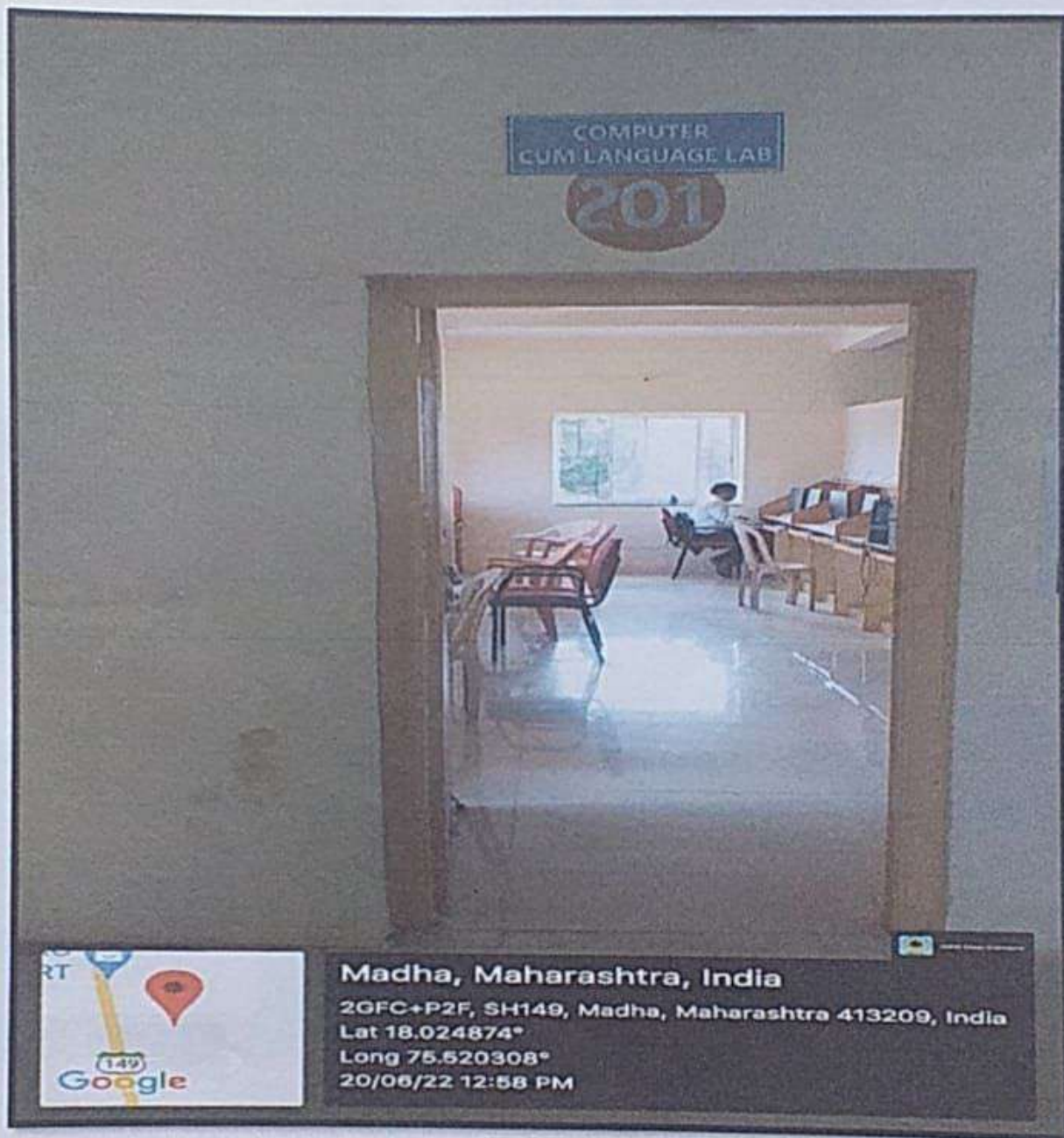

Computer cum Language Lab and E-facility

Co-ordinator,
I.Q.A.C.

Arts & Commerce College,
Madha, Dist. Solapur.



Principal,
Arts & Commerce College
Madha, Dist. Solapur